

# HUMANITARIAN AID SUPPORT

FOOD SUPPLIES / MEDICAL SUPPLIES / FREIGHT & LOGISTICS SUPPORT



# CITIES EFFECTED BY THE EARTHQUAKE IN TURKEY



# IMMEDIATE RESPONSE ITEMS MODULAR ACCOMONDATION

Didar Asia division provides several shelter & relief solutions to those affected in times of crisis or displacement. This includes the provision of basic items such as lighting, and blankets through to the larger scale construction projects of modular accommodation facilities.



# IMMEDIATE RESPONSE ITEMS MODULAR ACCOMONDATION

3x7 Living Containers  
Capacity: 500 pcs/week

<https://youtu.be/uvVO7MPO-Wg>

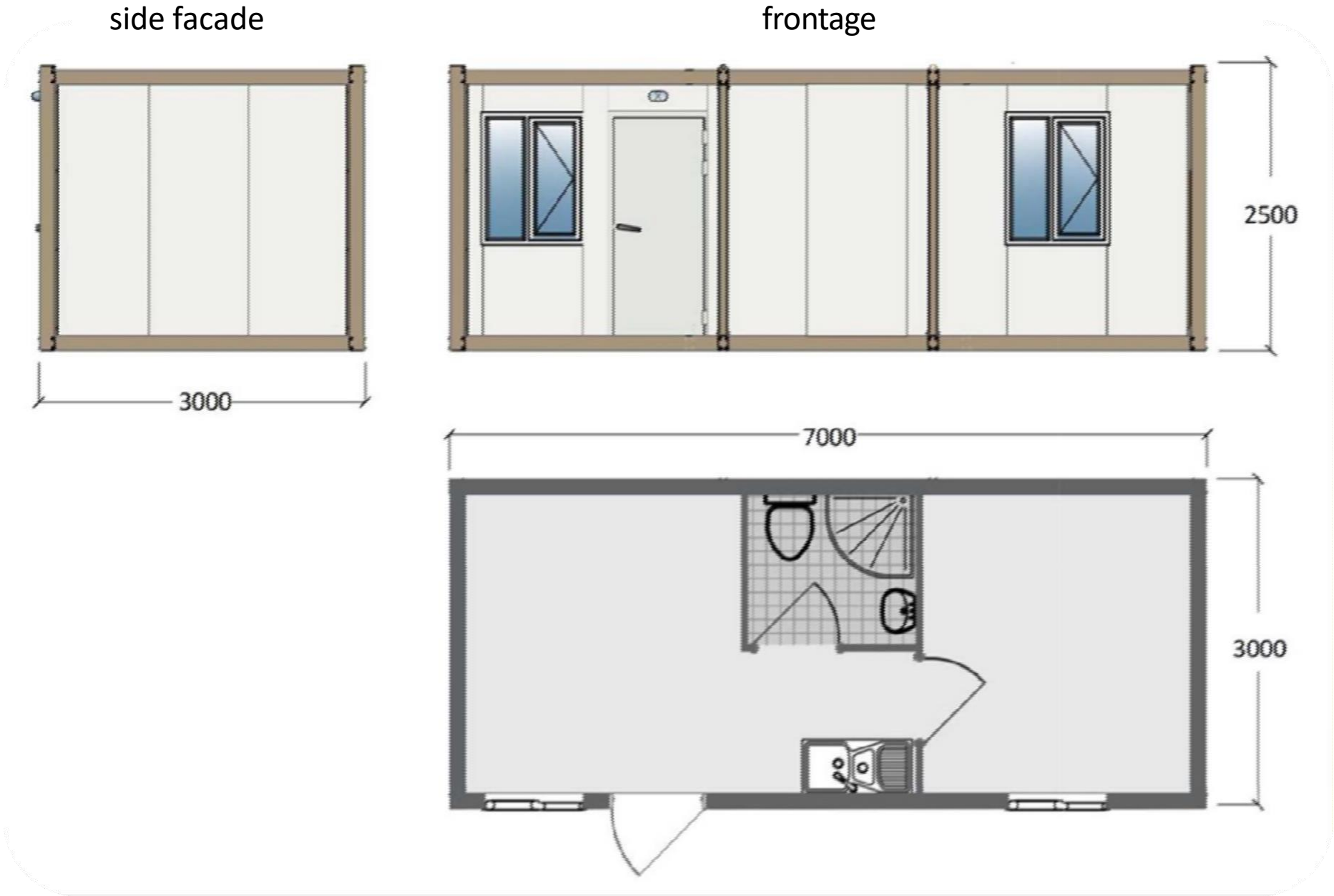

# IMMEDIATE RESPONSE ITEMS MODULAR ACCOMONDATION

3x7 Living Containers  
Capacity: 500 pcs/week



# IMMEDIATE RESPONSE ITEMS MODULAR ACCOMONDATION

6,55x5,8 = 40 m<sup>2</sup> Living Container House  
Capacity: 250 pcs/week



[https://youtu.be/U\\_nckZsbUo8](https://youtu.be/U_nckZsbUo8)

# IMMEDIATE RESPONSE ITEMS MODULAR ACCOMONDATION

6,55x5,8 = 40 m<sup>2</sup> Living Container House  
Capacity: 250 pcs/week

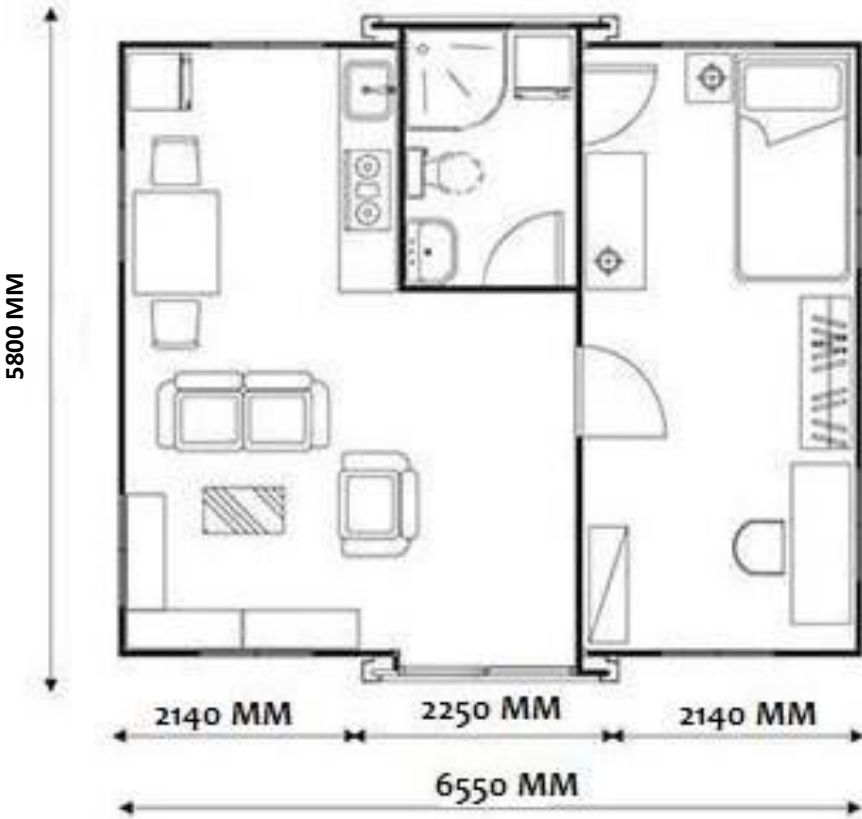

[https://youtu.be/U\\_nckZsbUo8](https://youtu.be/U_nckZsbUo8)

# IMMEDIATE RESPONSE ITEMS MODULAR ACCOMONDATION (SHOWER)

3x7 Abulation Containers (Toilet & Shower)  
Capacity: 200 pcs/week

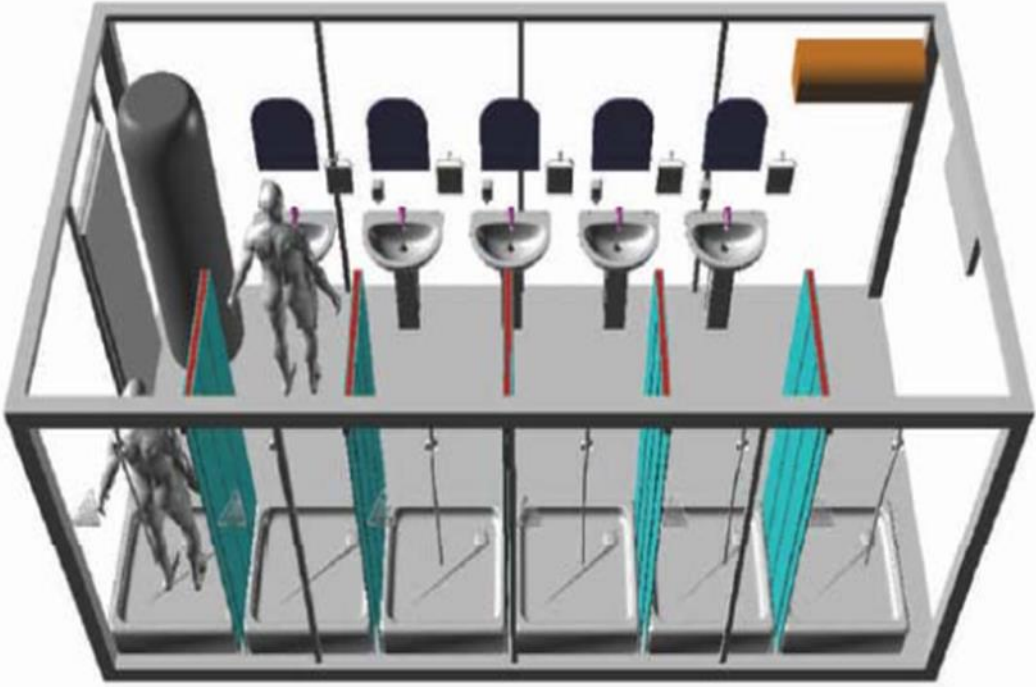



# IMMEDIATE RESPONSE ITEMS MODULAR ACCOMONDATION (TOILET)

3x7 Abulation Containers (Toilet & Shower)  
Capacity: 200 pcs/week

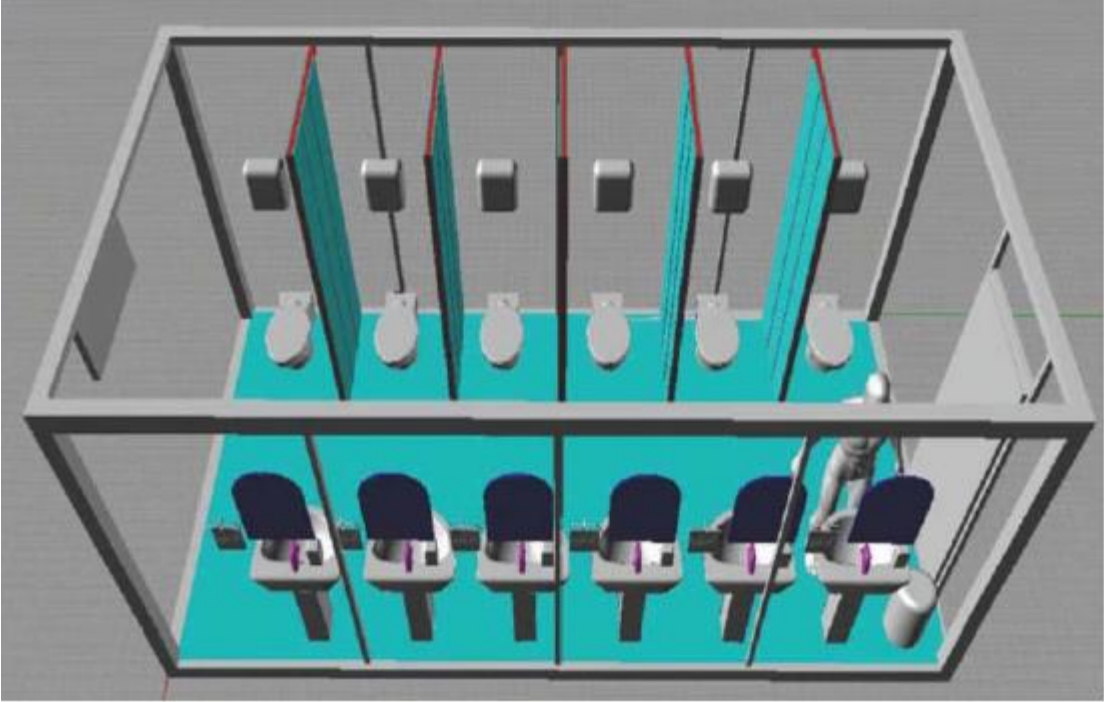

# IMMEDIATE RESPONSE ITEMS MODULAR ACCOMONDATION ON WHEELS (TOILET)

3x7 Abulation Containers (Toilet & Shower)  
Capacity: 200 pcs/week

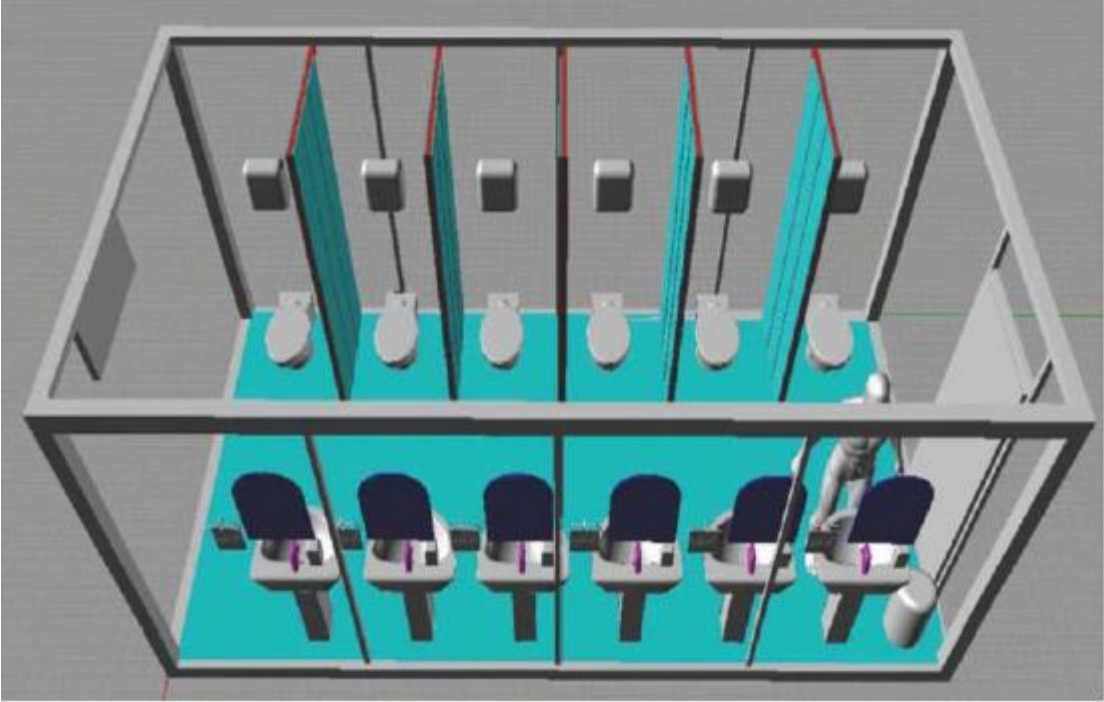

# IMMEDIATE RESPONSE ITEMS ELIPS AID TENTS

4x6 Elips Aid Tent  
Capacity: 3000 pcs/week



<https://youtu.be/b5tqwG1f4E0>



# IMMEDIATE RESPONSE ITEMS RELIEF TENT 3.2\*3.7 M

3.2\*3.7M Relief Tent - China  
Stock: 5,000 Tents



# IMMEDIATE RESPONSE ITEMS RELIEF TENT 3.2\*3.7 M

3.2\*3.7M Relief Tent - China

Stock: 5,000 Tents



Tent parameter :

Specifications :

**Long 3.7 m / Wide 3.2 m / Edge high 1.75m / Top high 2.67m**

**Usable area : 12 M2**

1. Structural form: the tent is a two-slope, full-frame structure. There are two windows on each side of the gable. The inside of the tent is supported by all steel pipes, and the surrounding is fixed by eight pull ropes and eight ground piles, which makes the tent more stable. The canopy can be opened upwards on all sides. The tent is reasonable in structure, safe and reliable in use, and can bear the load of force 8 wind and 8 cm thick snow at the same time ;

2. Tent fabric is made of sky blue waterproof 600DPVC inner layer of 300g cotton felt, lined with polyester tafri cloth, doors and windows can be opened large area and equipped with gauze mesh, with moisture-proof, dust prevention, mosquito prevention, ventilation and other functions ;

3. The internal rod is welded three-way and four-way steel pipe with diameter of 28mm. Wall thickness 1.2mm. Steel pipe with full body diameter of 25mm. Wall thickness 1.0mm, we factories use of high oxygen welding machine, after pickling, phosphating, rust prevention treatment, spraying, at normal temperature, can be maintained for five years without rust. The structure of the tent is simple and convenient, 6 people can be set up in 20 minutes, and removed in 10 minutes;

4. Packaging: the inner packaging of the canopy and accessories shall be sewn with the same canopy fabric, and the canopy and accessories shall be filled

inside, and the inspection sheet, product packaging sheet and tent operation instructions shall be placed inside the canopy package; The bracket is packaged separately.

5. Each tent weights 60kg, tent packing outer size: 0.18m\*2.10m\*0.18m, sailcloth packing outer size: 1m\*0.5m\*0.5m.

# IMMEDIATE RESPONSE ITEMS WOOD BURNING STOVE

Thickness: 0,70 mm  
Stove Top: Cast Iron  
Dimension: 36 cm  
Height: 70 cm  
Weight: 16 Kg



Capacity: 5000 pcs/week

## IMMEDIATE RESPONSE ITEMS FREIGHT & LOGISTICS EXPERTISE

DIDAR ASIA has significant experience delivering large product volumes in time-critical scenarios. Through our collaboration with global freight partners, including DHL/DSV, CH Robinson and Kuehne & Nagel, we can provide governments, healthcare facilities, the corporate sector and not-for-profit organizations with guaranteed logistics solutions in today's volatile market.

In support of Turkey amidst the current crisis, DIDAR ASIA is offering the following solutions in terms of freight and logistics aid:

- Flights from Asia, America, the UK and Europe into Poland and surrounding countries
- Assistance in customs clearance and import records
- Dedicated team of logistics experts to provide assistance to internal teams



GLOBAL PRESENCE  
LOCAL SERVICE





SANTÉ GLOBAL  
**6 PILLARS OF TRUST™**



**MITIGATING THE RISK**

Out of the box thinkers, creating and innovating solutions - analysing and mitigating all potential risks for a seamless, smarter & stronger solution.

**SUPPLIER VALIDATION**

Our supply teams engage with top tier law firms in countries of origin to negotiate, validate supplier legitimacy & ability to supply.

**COMPLIANCE & AUTHENTICITY**

Our global legal teams understand the complexities of multi-national agreements, giving peace of mind in cost and supply certainty.

**SPEED & SCALABILITY**

Our strength lies in our dedicated, clear thinking & problem-solving team - enabling the fastest possible response & ability to scale.

**GLOBAL SOURCING TEAMS**

Staff on the ground in over 28 locations, all standing 100% behind consistent quality, cost & delivery and enabling a 24/7 response service.

**EXPERIENCED IN DISASTER RESPONSE**

Santé are experienced in assisting the corporate sector, governments & NGOs to respond to disruptive & threatening events.





**didar**asia  
Group

